



15 Garvey Close

Thornwell, Chepstow, NP16 5TD

£1,000 PCM



Description

* Mid Link Property * Two Bedrooms * Hall * Kitchen with Integrated Single Oven and Grill, 4 Ring Gas Hob with Extractor Over, Space for Fridge/Freezer, Space and Plumbing for Washing Machine * Living/Dining Room * Bathroom with Mixer Tap Shower * Gas Central Heating * Double Glazed * Enclosed Rear Garden * Allocated Parking * Close to M4 Motorway Link and Local Amenities * Unfurnished * Available from 15th May 2024

Accommodation

KITCHEN

9'9" x 7'6"

with Wooden Framed Double Glazed Window to Front Elevation, Integrated Single Oven and Grill, 4 Ring Gas Hob with Extractor Over, Space for Fridge/Freezer, Space and Plumbing for Washing Machine, Tiled Splash Backs, Vinyl Flooring.

LIVING/DINING ROOM

14'2" x 11'10"

with uPVC Double Glazed Doors to Rear Elevation.

LANDING

5'0" Max x 3'2" Max

with Doors to Bedrooms 1 & 2, and Bathroom.

BEDROOM 1

11'10" Max x 8'11"

with Wooden Framed Double Glazed Window to Rear Elevation.

BEDROOM 2

11'10" x 8'3" Min

with Wooden Framed Double Glazed Window to Rear Elevation.

BATHROOM

6'4" x 5'6"

White Suite Comprising of Side Panel Bath with Mixer Tap Shower Over, Wash Hand Basin, Low Level W.C., Tiled Splash Backs, Extractor Fan, Vinyl Flooring.

REAR GARDEN

Enclosed Low Maintenance Enclosed Rear Garden with Small Terrace Area, Remainder to Lawn, Gate to Rear Elevation.

PARKING

Allocating Parking.

Ground Floor

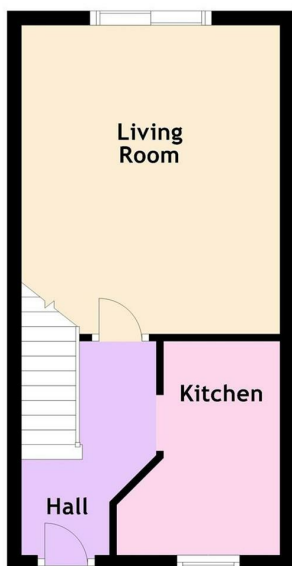

First Floor

